



**Woodlea Avenue  
York  
YO26 5JU**

**Offers in Excess of £243,000**

**bettermove**

# Woodlea Avenue York

Bettermove are proud to present this 3 bedroom terraced house in York available with no forward chain.

The property benefits from double glazing, gas central heating throughout.

The council tax band is B.

The interior of this property comprises a spacious living room, dining room and fitted kitchen on the ground floor. The first floor consists of 3 bedrooms and the family bathroom. The exterior boasts a private rear garden, perfect for enjoying the summer months.

Located in the popular village of Acomb, the property is close to a range of amenities, including shops, supermarkets, restaurants and pubs. Excellent transport connections can be found from the A1237, A59 and many local bus routes.

This exciting opportunity should not be missed! All enquiries can be made through Bettermove on 0330 004 0050.

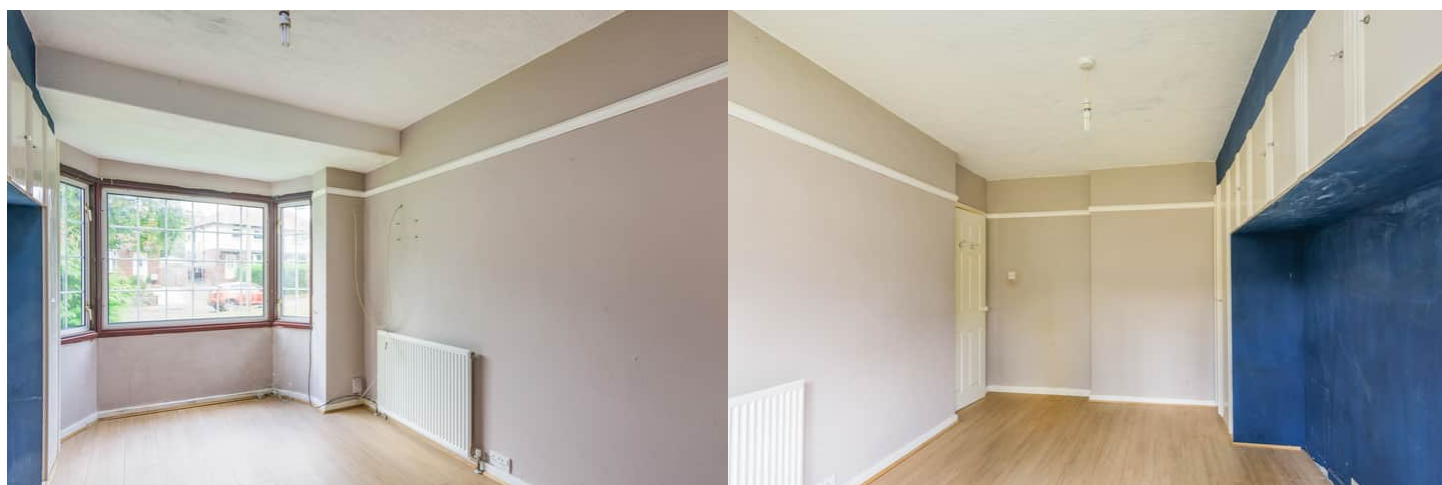

# YO26 5JU - 60 Woodlea Avenue, York

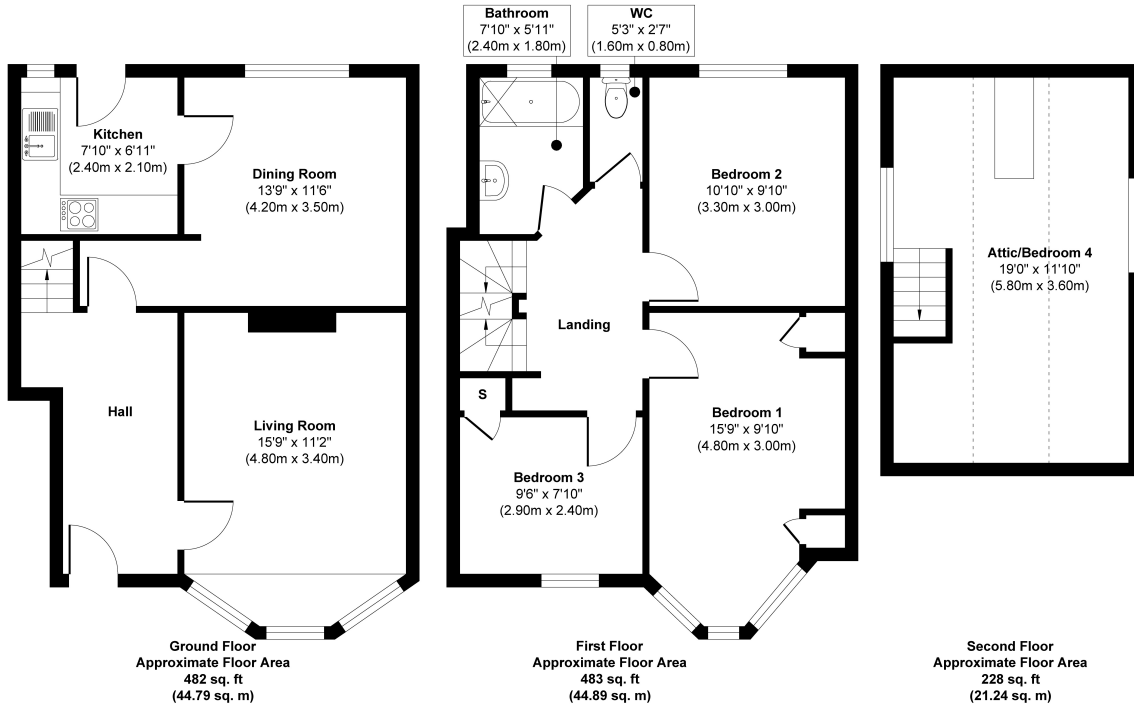

## Approx. Gross Internal Floor Area 1193 sq. ft / 110.92 sq. m

Whilst every attempt has been made to ensure the accuracy of the floor plan contained here, measurements of doors, windows, rooms and any other items are approximate and no responsibility is taken for any error, omission, or mis-statement. The measurements should not be relied upon for valuation, transaction and/or funding purposes. This plan is for illustrative purposes only and should be used as such by any prospective purchaser or tenant.

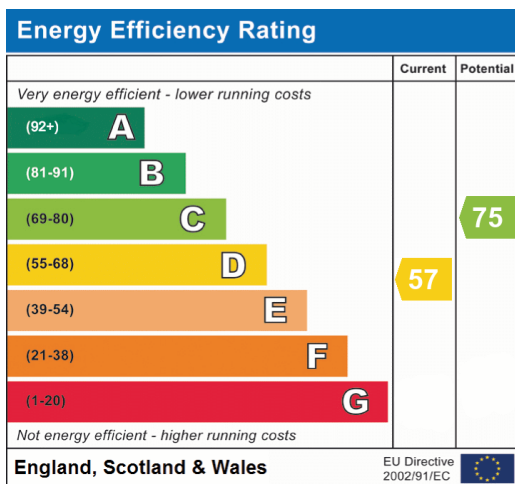



20-22 Bridge End, Leeds, LS1 4DJ  
t: 0330 004 0050 e: hello@bettermove.co.uk  
[www.bettermove.co.uk](http://www.bettermove.co.uk)