



**9 North Leas Drive
Bridlington
East Riding of Yorkshire
YO16 6JJ**

Offers in Excess of £195,000

bettermove

North Leas Drive Bridlington

Bettermove are proud to present this 2 bedroom semi-detached house in the sought after area of Bridlington.

The property benefits from double glazing, gas central heating throughout and has ample off street parking available via the driveway. The council tax band is B.

The property is tenanted and will be sold with tenants in situ for immediate investment - rental yields can be obtained through Bettermove.

The interior of this well presented property comprises a spacious living room, fitted kitchen, two double bedrooms, the family bathroom, study room with access to the second shower room. The exterior boasts a private rear garden, perfect for enjoying the summer months.

Located in the popular seaside town of Bridlington, the property is close to a range of amenities, including shops, supermarkets, restaurants and pubs. Excellent transport connections can be found from the A614, A615 and many local bus routes.

This exciting opportunity should not be missed! All enquiries can be made through Bettermove on 0330 004 0050.



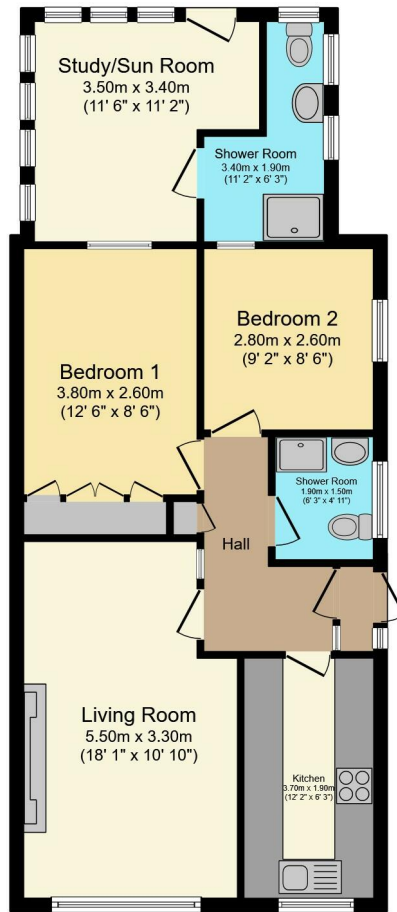

Total floor area 69.7 sq.m. (751 sq.ft.) approx

This floor plan is for illustrative purposes only. It is not drawn to scale. Any measurements, floor areas (including any total floor area), openings and orientation are approximate. No details are guaranteed, they cannot be relied upon for any purpose and they do not form part of any agreement. No liability is taken for any error, omission or misstatement. A party must rely upon its own inspection(s). Plan produced for Purplebricks. Powered by www.focalagent.com

Energy Efficiency Rating		
	Current	Potential
Very energy efficient - lower running costs		
(92+) A		
(81-91) B		85
(69-80) C	69	
(55-68) D		
(39-54) E		
(21-38) F		
(1-20) G		
Not energy efficient - higher running costs		
England, Scotland & Wales	EU Directive 2002/91/EC	



20-22 Bridge End, Leeds, LS1 4DJ
t: 0330 004 0050 e: hello@bettermove.co.uk
www.bettermove.co.uk