



**17 Alexandra Drive
Liverpool
Merseyside
L17 8TB**

Offers in Excess of £234,000

bettermove

17 Alexandra Drive Liverpool

Bettermove are proud to present this well presented 2 bedroom duplex flat in Liverpool available with no forward chain and welcoming cash buyers only.

The property benefits from double glazing, gas central heating throughout and has off street parking available via an allocated parking spot. The council tax band is C.

This is a leasehold property with 100 years remaining on the lease; the ground rent is £387 per annum and the service charge is £1,972 per annum.

The interior of this beautifully presented property comprises a spacious living room and the fitted kitchen on the lower floor. The ground floor consists of two bedrooms, including the master bedroom with an ensuite bathroom and a second bathroom.

Located in a popular residential area of Liverpool next to Sefton and Princes Park, the property is close to a range of amenities, including shops, supermarkets, restaurants and pubs. Excellent transport connections can be found from St Michaels Train Station and many local bus routes available nearby.

This exciting opportunity should not be missed! All enquiries can be made through Bettermove on 0330 004 0050.

You can secure the purchase immediately by paying an exclusivity deposit of £1,000.

This is not an additional fee and is returned to you on completion.

Paying this deposit ensures that the seller takes the property off the market and reserves it exclusively for you. Therefore, eliminating the risk of being gazumped by another buyer, and incurring aborted costs.



Floor plan

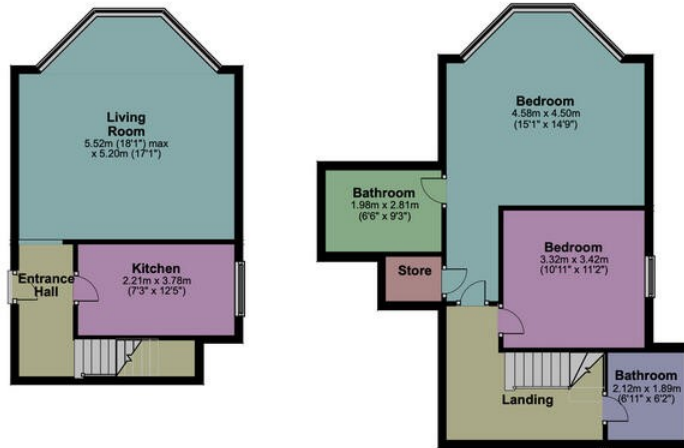

Energy Efficiency Rating		
	Current	Potential
<i>Very energy efficient - lower running costs</i>		
(92+) A		
(81-91) B		
(69-80) C		78
(55-68) D	64	
(39-54) E		
(21-38) F		
(1-20) G		
<i>Not energy efficient - higher running costs</i>		
England, Scotland & Wales	EU Directive 2002/91/EC	



20-22 Bridge End, Leeds, LS1 4DJ
t: 0330 004 0050 e: hello@bettermove.co.uk
www.bettermove.co.uk