



**Hillsway
Chellaston
Derby
DE73 6RN**

Offers In Excess Of £258,000

bettermove

Hillsway

Derby

Bettermove are proud to present this 3 bedroom detached bungalow in Chellaston available with no forward chain.

The property benefits from double glazing, gas central heating throughout and has off street parking available via the drive and garage.

The council tax band is C.

The interior of this property comprises a spacious living room, shower room, bedroom and fitted kitchen on the ground floor. The first floor consists of 2 bedrooms. The exterior boasts a private rear garden, perfect for enjoying the summer months.

Located in the popular residential village of Chellaston, the property is close to a range of amenities, including shops, supermarkets, restaurants and pubs. Excellent transport connections can be found from the A514, A50 and local bus routes.

This exciting opportunity should not be missed! All enquiries can be made through Bettermove on 0330 004 0050.



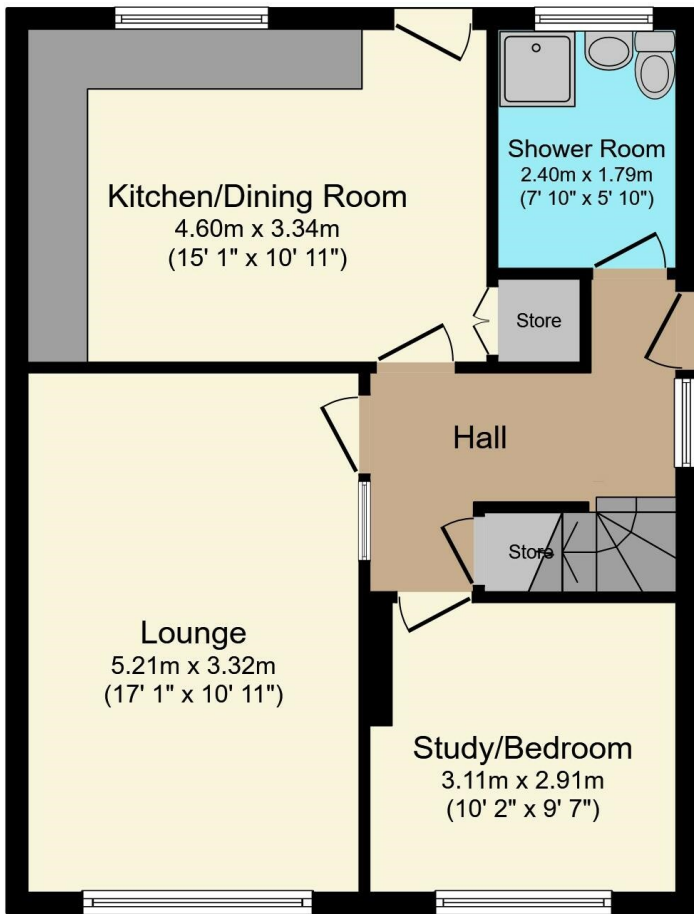

Ground Floor

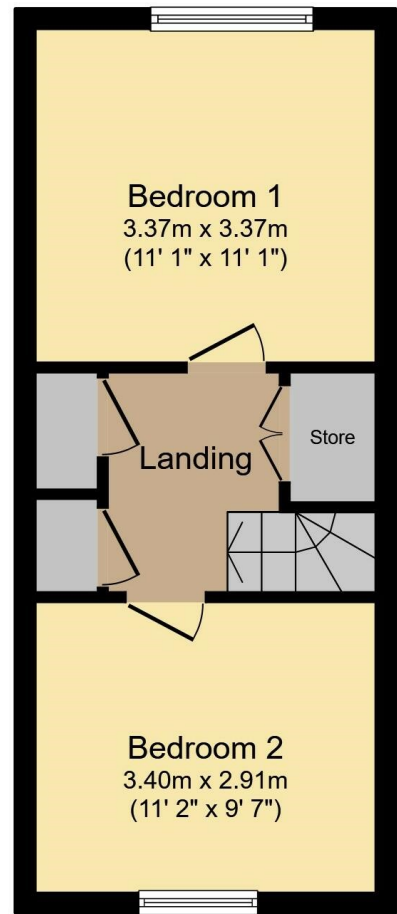

First Floor

Total floor area 85.4 m² (919 sq.ft.) approx

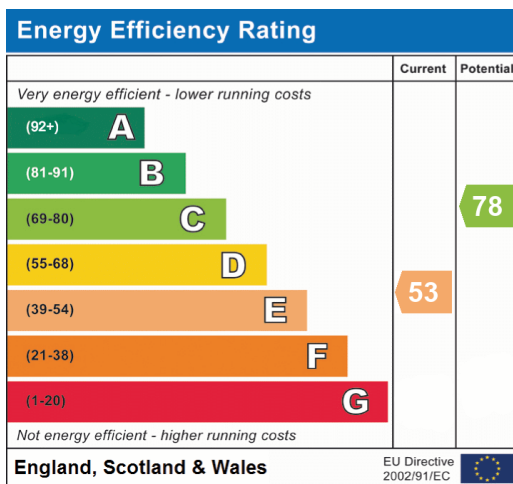



20-22 Bridge End, Leeds, LS1 4DJ
t: 0330 004 0050 e: hello@bettermove.co.uk
www.bettermove.co.uk