



**Moorbrook Mill Drive
New Mill
Holmfirth
West Yorkshire
HD9 1JL**

Offers In Excess Of £312,000

bettermove

Moorbrook Mill Drive

Holmfirth

Bettermove are proud to present this 4 bedroom Town House in New Mill available with no forward chain.

The property benefits from double glazing, gas central heating throughout and has off street parking available via the driveway and the garage. The council tax band is D.

The interior of this beautifully presented property comprises a spacious and open plan fitted kitchen with a dining area, study and a convenient WC on the ground floor. The first floor consists of the living room, one double bedroom and the bathroom. The second floor has two double bedrooms and a bathroom. The exterior

Located in the popular village of New Mill, the property is close to a range of amenities, including shops, supermarkets, restaurants and pubs. Excellent transport connections can be found from Brockholes Train Station, the A635 and many local bus routes.

This exciting opportunity should not be missed! All enquiries can be made through Bettermove on 0330 004 0050.



Moorbrook Mill Drive, New Mill, Holmfirth
Approximate Gross Internal Area
Main House = 120 Sq M/1293 Sq Ft
Garage = 13 Sq M/140 Sq Ft
Total = 133 Sq M/1433 Sq Ft

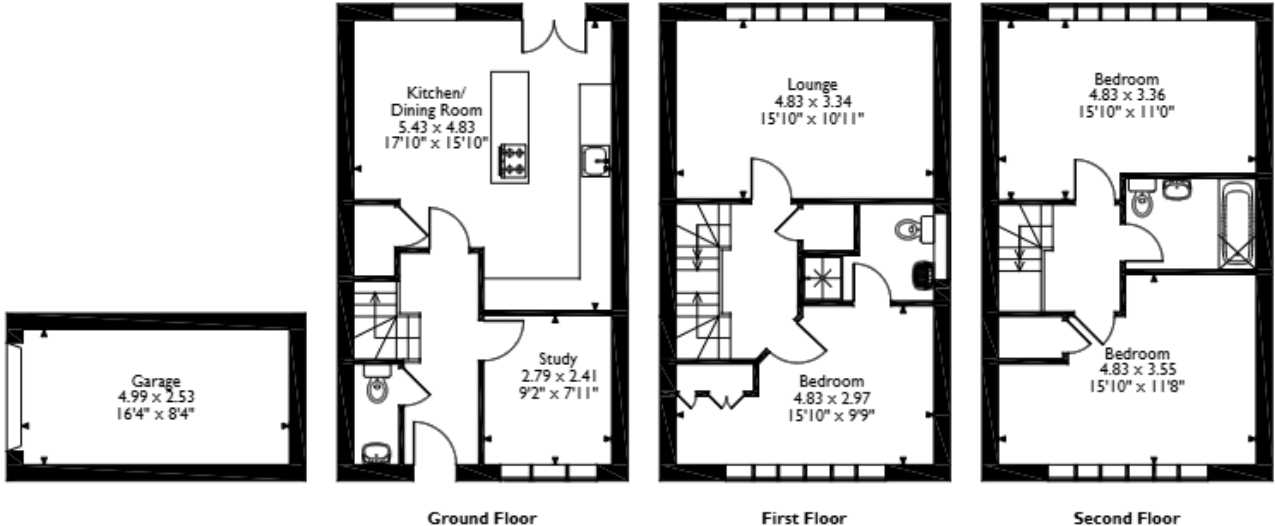

Ground Floor **First Floor** **Second Floor**
Please note that the location of doors, windows and other items are approximate and this floorplan is to be used for illustrative purposes only. Unauthorized reproduction is prohibited.



20-22 Bridge End, Leeds, LS1 4DJ
t: 0330 004 0050 e: hello@bettermove.co.uk
www.bettermove.co.uk