



**Pulvertoft Lane
Boston
Lincolnshire
PE21 8TB**

Offers in Excess of £108,000

bettermove

Pulvertoft Lane

Boston

Bettermove are proud to present this 2 bedroom terraced house in Boston available with no forward chain.

The property benefits from double glazing, gas central heating throughout. The council tax band is A.

The interior of this beautifully presented property comprises a spacious living room, dining room and fitted kitchen on the ground floor. The first floor consists of 2 bedrooms and the family bathroom. The exterior boasts a private rear garden, perfect for enjoying the summer months.

Located in the popular town of Boston, the property is close to a range of amenities, including shops, supermarkets, restaurants and pubs. Excellent transport connections can be found from A16, A52 and Local Bus Routes. This exciting opportunity should not be missed! All enquiries can be made through Bettermove on 0330 004 0050.



Ground Floor

Approx. 38.4 sq. metres (413.6 sq. feet)



First Floor

Approx. 33.5 sq. metres (360.9 sq. feet)

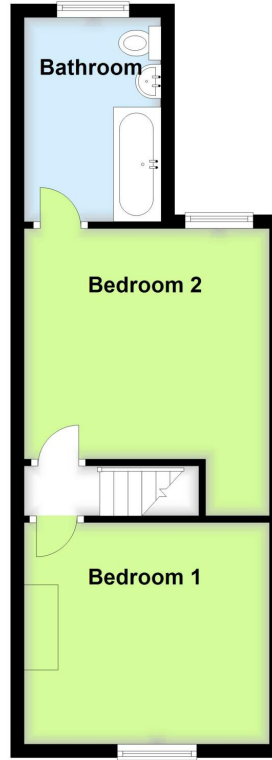

Total area: approx. 72.0 sq. metres (774.6 sq. feet)

Energy Efficiency Rating		
	Current	Potential
<i>Very energy efficient - lower running costs</i>		
(92+) A		
(81-91) B		86
(69-80) C		
(55-68) D	61	
(39-54) E		
(21-38) F		
(1-20) G		
<i>Not energy efficient - higher running costs</i>		
England, Scotland & Wales	EU Directive 2002/91/EC	



20-22 Bridge End, Leeds, LS1 4DJ
t: 0330 004 0050 e: hello@bettermove.co.uk
www.bettermove.co.uk