



Ruskin Road
Lancaster
Lancashire
LA1 2EB

Offers in Excess of £112,000

bettermove

Ruskin Road Lancaster

Bettermove are proud to present this 3 bedroom Terraced House in Lancaster available with no forward chain.

The property benefits from double glazing, gas central heating throughout and has ample on street parking available nearby. The council tax band is A.

The property is tenanted and will be sold with tenants in situ for immediate investment - rental yields can be obtained through Bettermove.

The interior of this property comprises a spacious living room and the fitted kitchen on the ground floor. The first floor consists of three bedrooms and the family bathroom. The exterior boasts a private rear garden, perfect for enjoying the summer months.

Located in the popular town of Lancaster, the property is close to a range of amenities, including shops, supermarkets, restaurants and pubs. Excellent transport connections can be found from the M6, the A683 and many local bus routes.

This exciting opportunity should not be missed! All enquiries can be made through Bettermove on 0330 004 0050.



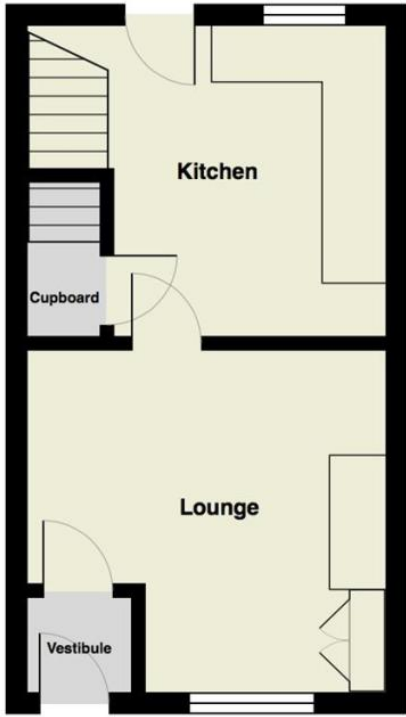



20-22 Bridge End, Leeds, LS1 4DJ
t: 0330 004 0050 e: hello@bettermove.co.uk
www.bettermove.co.uk