



**Elder Grove
Wolverhampton
West Midlands
WV11 1RX**

Offers in Excess of £124,000

bettermove

Elder Grove Wolverhampton

Bettermove are proud to present this 2 bedroom First Floor Flat in Wolverhampton, available with no forward chain.

The property benefits from double glazing, electric heating throughout and has an allocated parking space available. The council tax band is B.

The property is tenanted and will be sold with tenants in situ for immediate investment - rental yields can be obtained through Bettermove.

This is a leasehold property with 104 years remaining on the lease; the ground rent and the service charge is £725 per annum combined.

The interior of this property comprises the spacious living room, the fitted kitchen, two bedrooms and the bathroom on the first floor of the building.

Located in a popular residential area of Wolverhampton, the property is close to a range of amenities, including shops, supermarkets, restaurants and pubs. Excellent transport connections can be found from the M6, Wolverhampton Train Station and Many local bus routes.

This exciting opportunity should not be missed! All enquiries can be made through Bettermove on 0330 004 0050.



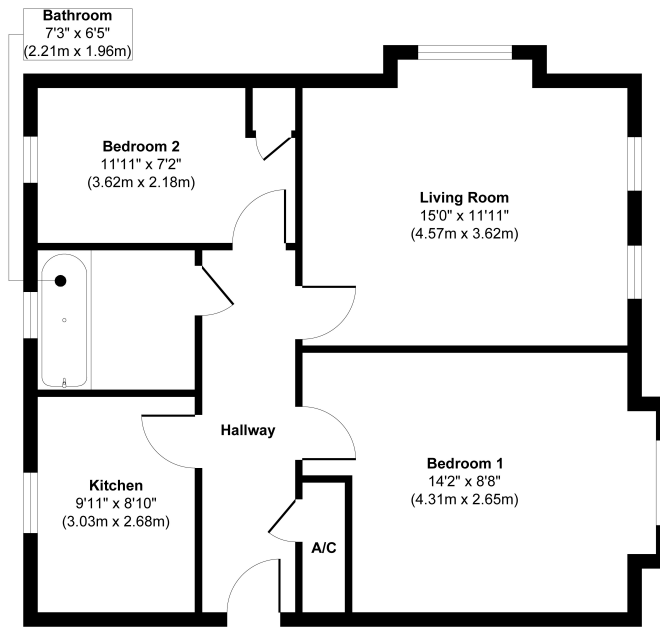

Floor Plan

Approx. Gross Internal Floor Area 674 sq. ft / 62.66 sq. m

Whilst every attempt has been made to ensure the accuracy of the floor plan contained here, measurements of doors, windows, rooms and any other items are approximate and no responsibility is taken for any error, omission, or mis-statement. The measurements should not be relied upon for valuation, transaction and/or funding purposes. This plan is for illustrative purposes only and should be used as such by any prospective purchaser or tenant.



20-22 Bridge End, Leeds, LS1 4DJ
t: 0330 004 0050 e: hello@bettermove.co.uk
www.bettermove.co.uk