

Rothwell Drive
Aughton
Ormskirk
Lancashire
L39 5AN

Offers in Excess of £225,000

bettermove

Rothwell Drive

Ormskirk

Bettermove are proud to present this impressive 3 bedroom Terraced House in the sought after area of Aughton.

The property benefits from double glazing, gas central heating throughout and has off street parking available via the private double driveway. The council tax band is C.

The interior of this beautifully presented property comprises a spacious and open plan kitchen/diner with access to the utility room and a separate living room on the ground floor. The first floor consists of three bedrooms and the family bathroom. The exterior of the property boasts a private rear garden accessed via the kitchen/ diner, perfect for enjoying the summer months.

Located in the popular town of Aughton, the property is close to a range of amenities, including shops, supermarkets, restaurants and pubs. Excellent transport connections can be found from the A59, the A58, the M58 and many local bus routes providing easy access into Ormskirk.

This exciting opportunity should not be missed! All enquiries can be made through Bettermove on 0330 004 0050.



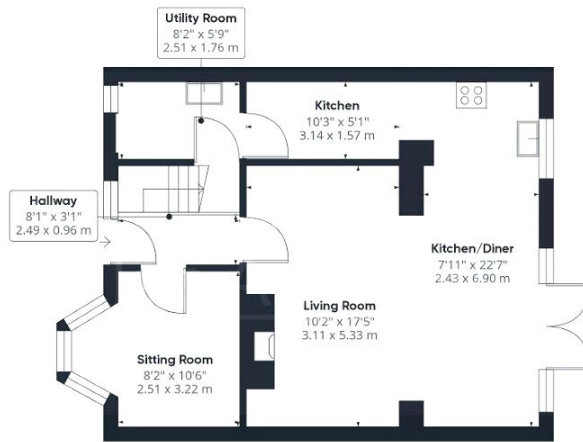

Ground Floor



Floor 1

Approximate total area⁹
1054.43 ft²
97.96 m²

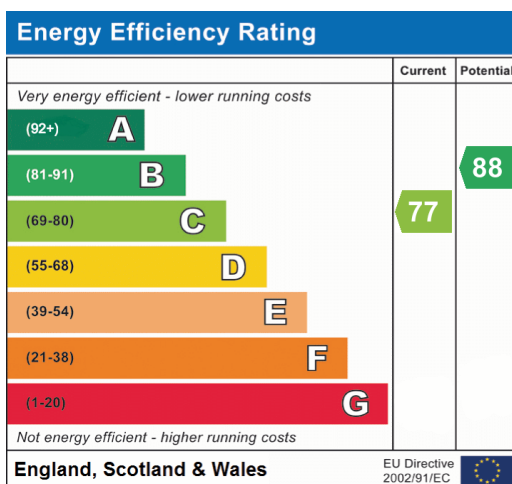



20-22 Bridge End, Leeds, LS1 4DJ
t: 0330 004 0050 e: hello@bettermove.co.uk
www.bettermove.co.uk

Please Note: These particulars, whilst believed to be accurate are set out as a general outline only for guidance and do not constitute any part of an offer or contract. Intending purchasers should not rely on them as statements of representations of fact, but must satisfy themselves by inspection or otherwise as to their accuracy. No person in this firm's employment has the authority to make or give any representation or warranty in respect of the property.