



**Tyersal Avenue
Bradford
West Yorkshire
BD4 8HJ**

Offers in Excess of £160,000

bettermove

Tyersal Avenue Bradford

Bettermove are proud to present this 3 bedroom Terraced House in the sought after area of Bradford.

The property benefits from double glazing, gas central heating throughout and has off street parking available via the driveway. The council tax band is B.

The interior of this property comprises a spacious living room, open plan fitted kitchen with dining area and a convenient WC on the ground floor. The first floor consists of three bedrooms and the family bathroom. The exterior boasts a private rear garden, perfect for enjoying the summer months.

Located in the popular residential area of Bradford, the property is close to a range of amenities, including shops, supermarkets, restaurants and pubs. Excellent transport connections can be found from New Pudsey Train Station and many local bus routes.

This exciting opportunity should not be missed! All enquiries can be made through Bettermove on 0330 004 0050.



BD4 8HJ - 71 Tyersal Avenue, Bradford

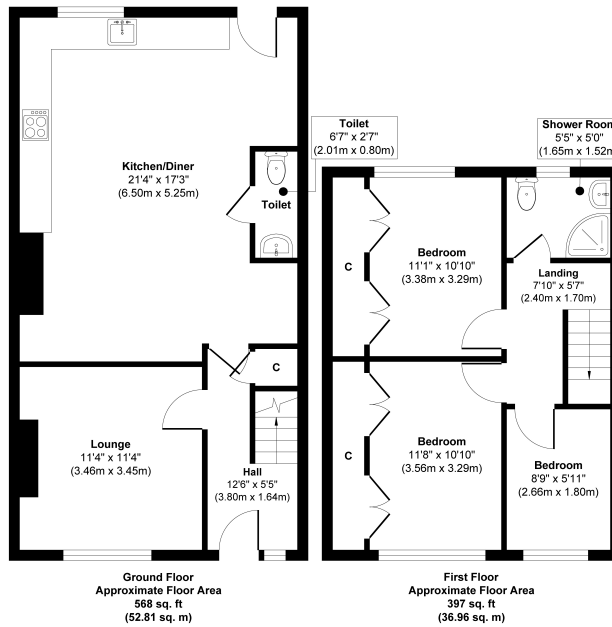

Approx. Gross Internal Floor Area 965 sq. ft / 89.77 sq. m

Whilst every attempt has been made to ensure the accuracy of the floor plan contained here, measurements of doors, windows, rooms and any other items are approximate and no responsibility is taken for any error, omission, or mis-statement. The measurements should not be relied upon for valuation, transaction and/or funding purposes. This plan is for illustrative purposes only and should be used as such by any prospective purchaser or tenant.

Energy Efficiency Rating		
	Current	Potential
Very energy efficient - lower running costs		
(92+) A		
(81-91) B		85
(69-80) C	71	
(55-68) D		
(39-54) E		
(21-38) F		
(1-20) G		
Not energy efficient - higher running costs		
England, Scotland & Wales	EU Directive 2002/91/EC	



20-22 Bridge End, Leeds, LS1 4DJ
t: 0330 004 0050 e: hello@bettermove.co.uk
www.bettermove.co.uk