



High Street
Cheltenham
Gloucestershire
GL52 6DA

Offers In Excess Of £123,000

bettermove

High Street Cheltenham

Bettermove are proud to present this 1 bedroom flat in cheltenham.

The property benefits from double glazing, gas central heating throughout and has off street parking available.

The council tax band is A.

This is a leasehold property with 50 years remaining on the lease; the ground rent is £35 half yearly and the service charge is £150pcm. The vendor has advised that the lease will be extended on completion at no further cost.

The interior of this beautifully presented property comprises a spacious living room, fitted kitchen, 1 bedroom and the bathroom.

Located in the popular town of Cheltenham, the property is close to a range of amenities, including shops, supermarkets, restaurants and pubs. Excellent transport connections can be found from the A435, A46 and many local bus routes.

This exciting opportunity should not be missed! All enquiries can be made through Bettermove on 0330 004 0050.



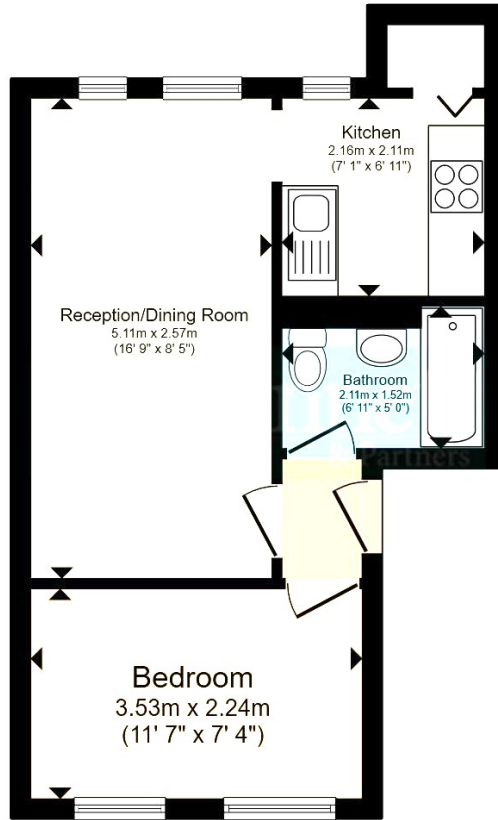

Total floor area 32.0 m² (344 sq.ft.) approx

This floor plan is for illustrative purposes only. It is not drawn to scale. Any measurements, floor areas (including any total floor area), openings and orientation are approximate. No details are guaranteed, they cannot be relied upon for any purpose and they do not form part of any agreement. No liability is taken for any error, omission or misstatement. A party must rely upon its own inspection(s). Powered by www.focalagent.com

| Energy Efficiency Rating | | |
|--|-------------------------|-----------|
| | Current | Potential |
| <i>Very energy efficient - lower running costs</i> | | |
| (92+) A | | |
| (81-91) B | | |
| (69-80) C | 73 | 78 |
| (55-68) D | | |
| (39-54) E | | |
| (21-38) F | | |
| (1-20) G | | |
| <i>Not energy efficient - higher running costs</i> | | |
| England, Scotland & Wales | EU Directive 2002/91/EC | |



20-22 Bridge End, Leeds, LS1 4DJ
t: 0330 004 0050 e: hello@bettermove.co.uk
www.bettermove.co.uk