



**Old Bidston Road
Birkenhead
Merseyside
CH41 8BL**

Offers In Excess Of £105,000

bettermove

Old Bidston Road Birkenhead

Bettermove are proud to present this 3 bedroom semi-detached house in Birkenhead available with no forward chain.

The property benefits from double glazing, gas central heating throughout.

The council tax band is A.

The interior of this beautifully presented property comprises a spacious living room, dining room, family bathroom and fitted kitchen on the ground floor. The first floor consists of 2 bedrooms. The second floor holds the third bedroom. The exterior boasts a private rear yard, perfect for enjoying the summer months.

Located in the popular town of Birkenhead, the property is close to a range of amenities, including shops, supermarkets, restaurants and pubs. Excellent transport connections can be found from the A5030, A59 and many local bus routes.

This exciting opportunity should not be missed! All enquiries can be made through Bettermove on 0330 004 0050.



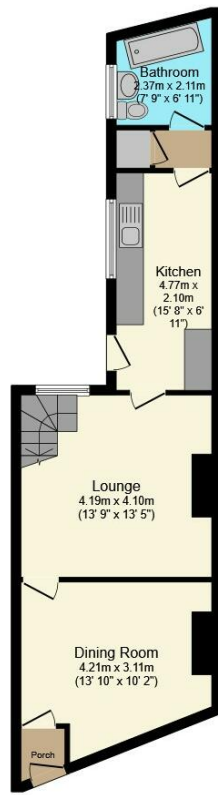

Ground Floor
Floor area 49.0 m²
(527 sq.ft.)

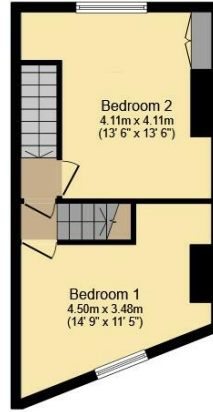

First Floor
Floor area 32.1 m²
(346 sq.ft.)

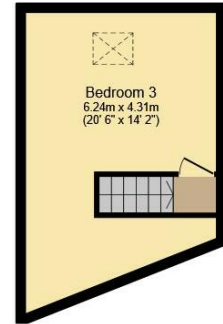

Second Floor
Floor area 24.2 m²
(261 sq.ft.)

TOTAL: 105.3 m² (1,133 sq.ft.)

This floor plan is for illustrative purposes only. It is not drawn to scale. Any measurements, floor areas (including any total floor area), openings and orientations are approximate. No details are guaranteed, they cannot be relied upon for any purpose and do not form any part of any agreement. No liability is taken for any error, omission or misstatement. A party must rely upon its own inspection(s). Powered by www.Propertybox.io

Energy Efficiency Rating		
	Current	Potential
<i>Very energy efficient - lower running costs</i>		
(92+) A		
(81-91) B		83
(69-80) C		
(55-68) D	56	
(39-54) E		
(21-38) F		
(1-20) G		
<i>Not energy efficient - higher running costs</i>		
England, Scotland & Wales	EU Directive 2002/91/EC	



20-22 Bridge End, Leeds, LS1 4DJ
t: 0330 004 0050 e: hello@bettermove.co.uk
www.bettermove.co.uk